

COPY TRAY UNIT-D1 INSTALLATION PROCEDURE

Follow the instructions in this booklet when installing the Copy Tray to its host copier.
For use with Canon copying machines only.

1 Unpacking

Open the cardboard box, and check to make sure that none of the parts indicated in Figure 1-1 is missing.

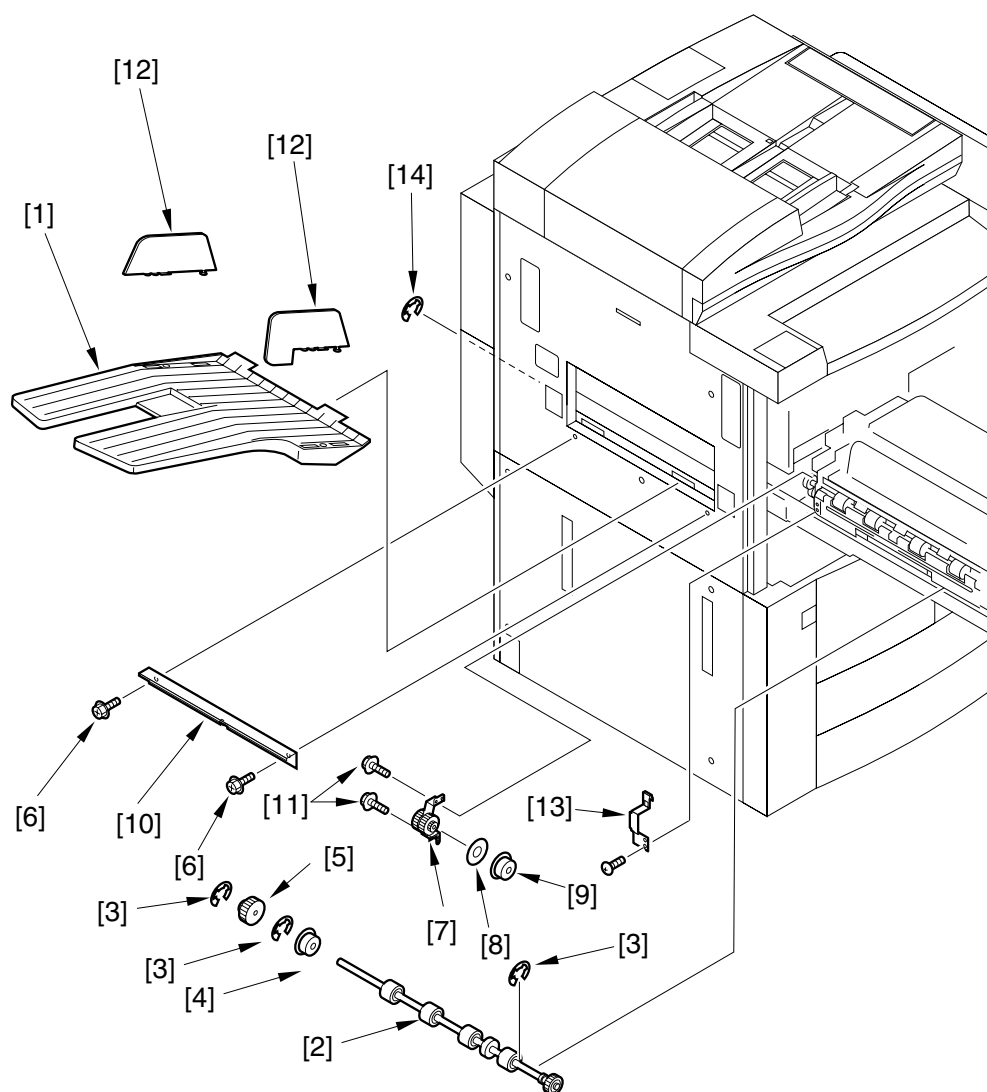

Figure 1-1

[1] Copy tray	1 pc.	[8] Spacer	1 pc.
[2] Delivery roller	1 pc.	[9] Bearing (small)	1 pc.
[3] E-ring (large)	3 pc.	[10] Reinforcing plate	1 pc.
[4] Bearing (large)	1 pc.	[11] RS tightening screws	2 pc.
[5] Gear	1 pc.	[12] Side guide plate (front, rear)	1 pc. each
[6] Tapping screw	2 pc.	[13] Delivery gear face plate	1 pc.
[7] Drive assembly	1 pc.	[14] E-ring (small)	1 pc.

2 Replacing the Delivery Gear

- 1) Open the front door, and slide out the fixing/feeding unit. (Be sure to slide it out fully while pushing on the stoppers on both side.)
- 2) Remove the transfer separation charging assembly cover, fixing/feeding unit releasing lever, and fixing roller knob.
- 3) Detach the fixing/feeding unit cover.
- 4) Remove the three screws, and detach the delivery roller guide.

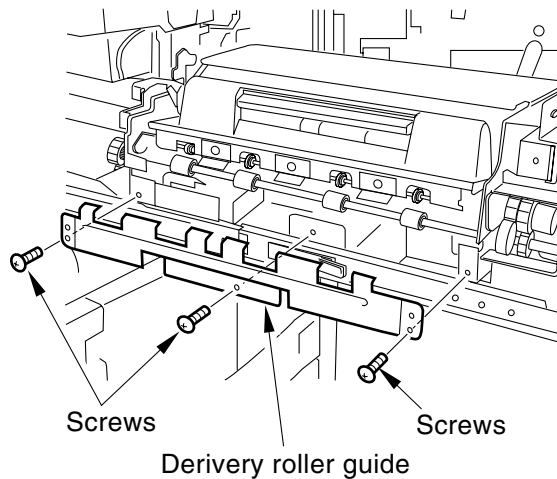

Figure 2-1

- 5) Open the upper delivery unit; then, remove one of the five plastic strips (i.e., middle one).

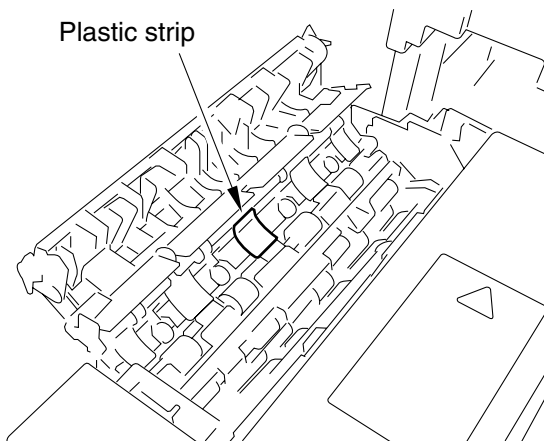

Figure 2-2

- 6) Remove the E-ring (one each) from the front and the rear of the delivery roller.

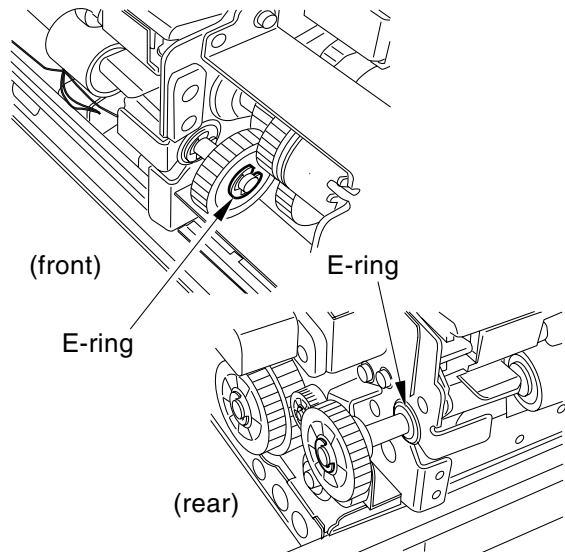

Figure 2-3

- 7) Remove the E-ring and the gear; then, remove the two screws, and detach the drive assembly.

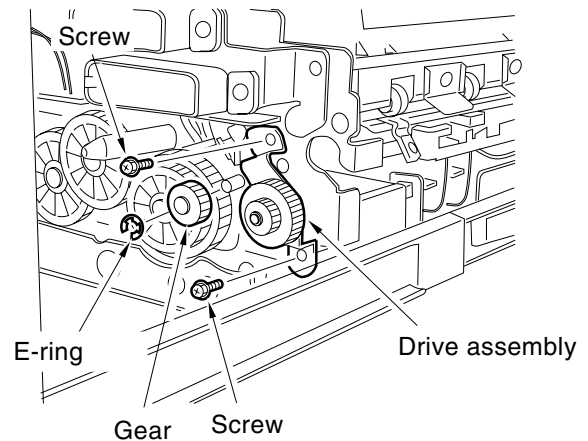

Figure 2-4

- 8) Remove the screw, and detach the positioning plate at the front of the upper external delivery assembly.

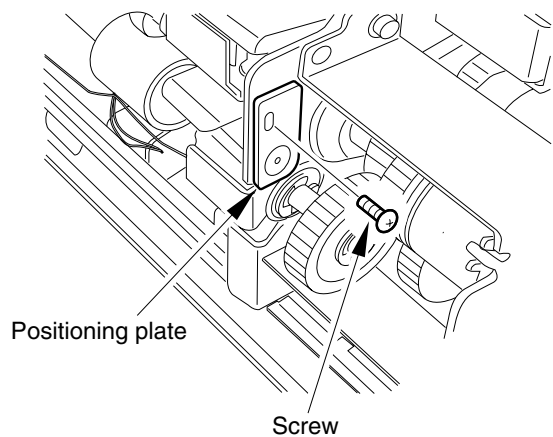

Figure 2-5

- 9) Fit the delivery roller that comes with the unit to the copier, and mount the rear bearing; then, mount the front and rear E-rings (large).

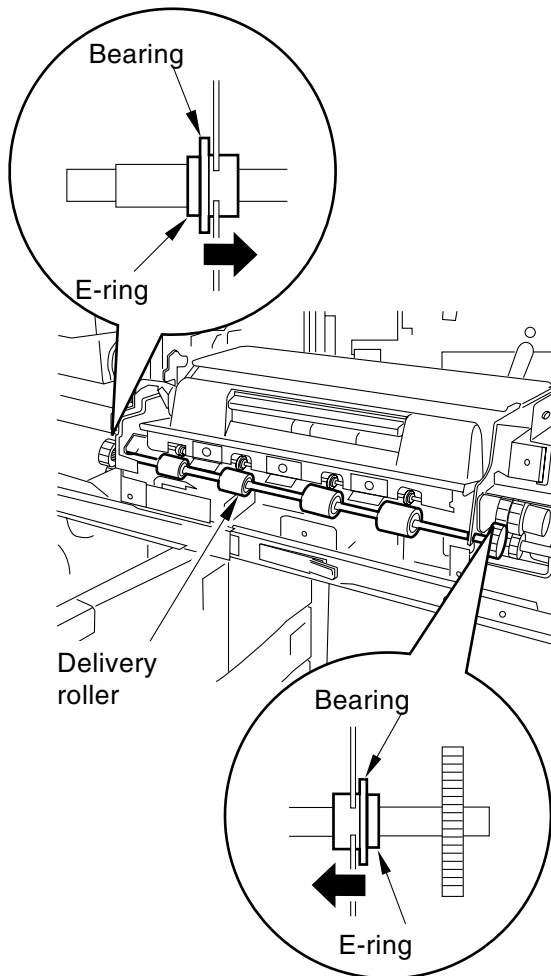

Figure 2-6

- 10) Mount the positioning plate at the upper external delivery assembly.
11) Mount the rear gear and E-ring (large).

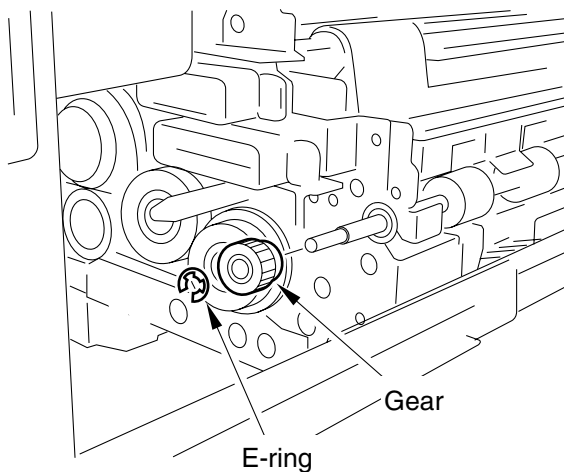

Figure 2-7

- 12) Fit the spacer and the bearing to the drive assembly that comes with the tray unit. Mount the drive assembly to the copier with two screws, and put back the gear removed in setp 7) and E-ring (small) come with the tray unit.

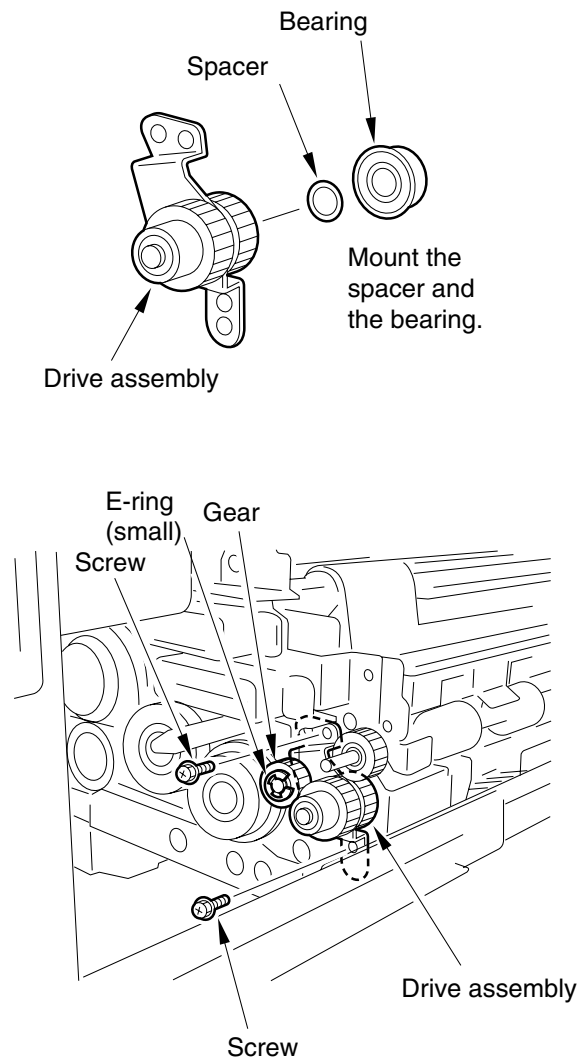

Figure 2-8

- 13) Remove the screws (one each), and remove the three curling guide plates.

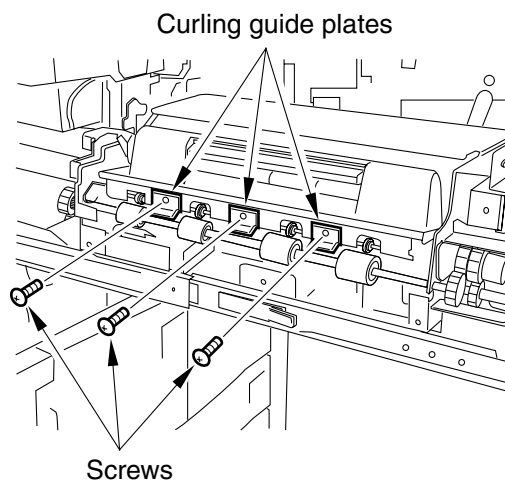

Figure 2-9

- 14) Mount the delivery roller guide removed in setp 4) using the fixing screw at the front and the center.
- 15) Put the delivery gear face plate over the rear of the delivery roller guide, and secure them together in place with a screw.

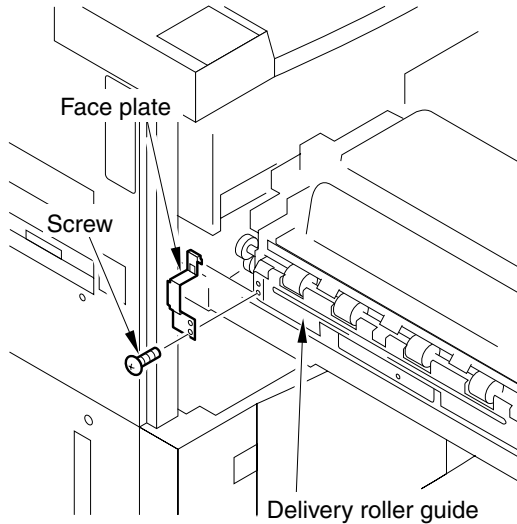

Figure 2-10

- 16) Mount the copy tray to the copier.

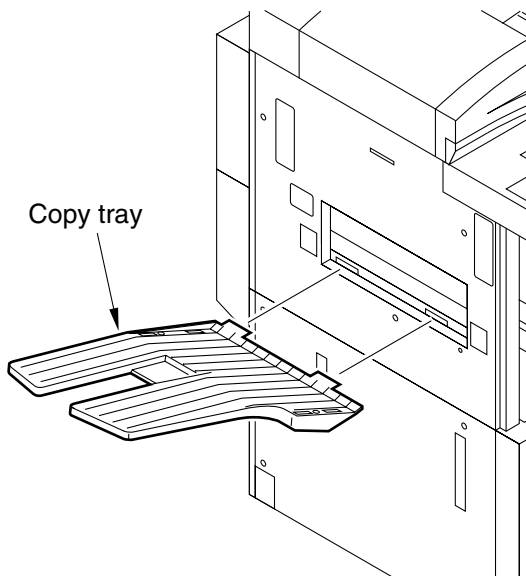

Figure 2-11

- 17) Mount the side guide plate (front, rear).
Be sure that the guide plates are oriented as shown in the figure.

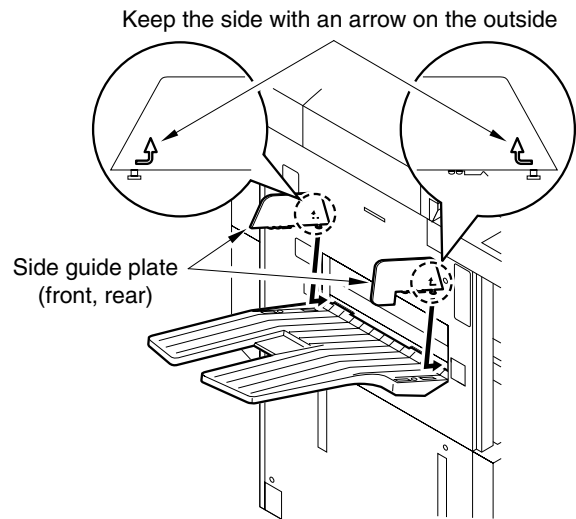

Figure 2-12

- 18) Mount the reinforcing plate to the bottom of the copy tray with two screws.

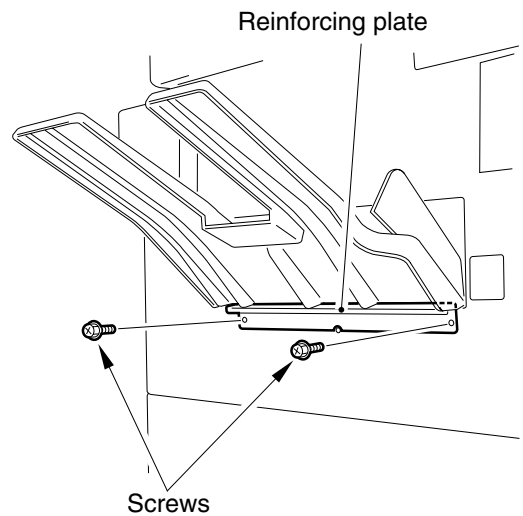

Figure 2-13